

# Tips for Best Artistic Results

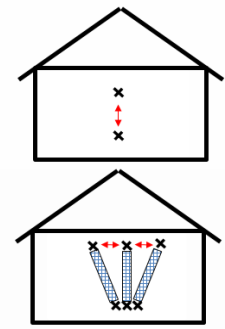

(Example of a Fan Trellis Design)

## Tools Required

- Tape Measure
- Pencil
- Level (or Plumb-Bob)
- Cordless Drill Gun w/#2 Philip Bit
- Household Scissors

- Sketch** out an outline of your design on a piece of paper
- Mark the actual location of where the “vertical” trellis Blocks will be mounted with a pencil. (The bottom Blocks “2<sup>nd</sup> Blocks” should be at least 12 inches off the ground to avoid concrete foundation.) Use a level, or a string plumb-bob to assure “up-down” straightness of the vertical trellis.
- Mark** all remaining dots approximately where the screws on the Blocks will be. (Remember to allow space for the footprint of the actual Blocks where they may intersect.)
- Follow** Steps 1-5 below to install each individual Garden Trellis, start with the “vertical” ones.
- Once** all of the trellis members are installed, the mesh should be tight. If not, remove the 2<sup>nd</sup> Block on the loose trellis and reposition the plastic buttons to the next shorter row in the mesh, and re-install in the same screw hole.
- For “Fan or Quad” Trellis, Install** a “Mid-Block” on all Scroll Trellis sections that are greater than 6 feet. Position the Mid-Block between the structure and the mesh at the halfway point and insert the two black buttons through the mesh and into the Block. Insert the screw and apply some caulking to the screw tip prior to installing the screw.

Visit [www.scrolltrellis.com](http://www.scrolltrellis.com) for creative applications



## Simple Instructions for Each Trellis Installation

- Install** the Block with the screw in it, refer to this as the 1<sup>st</sup> Block (make sure the two black buttons are against the structure)  
(Apply a marble size blob of caulking sealer on all screw points prior to installing on a building)
- Remove** screw and (2) plastic buttons from opposite Block (2<sup>nd</sup> Block) being careful not to drop pieces and re-install buttons through the mesh at the desired trellis length
- Pull** 2<sup>nd</sup> Block until mesh is straight, then start screw on a slight Angle until screw starts to bite
- With** the screw partially installed, rotate 2<sup>nd</sup> Block so the Mesh is tight and then completely install the screw in place
- Trim** any excess mesh with household scissors
- Install “Mid-Block” support** when overall trellis exceeds 6 feet

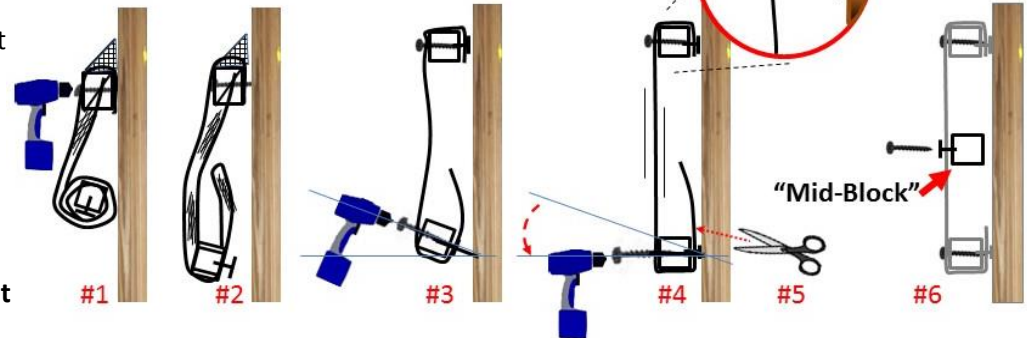

# Creative Uses for the Scroll Trellis Garden Trellis



